

Drawing name: K:\SNA_Aviation\093504000_Nampo-MP\CADD\ALP\Nampo-TermArea-FD.dwg TAP (2) Nov 23, 2010 2:00pm by: adam.novak
 This document, together with the concepts and designs presented herein, as an instrument of service, is intended only for the specific purpose and client for which it was prepared. Reuse or improper reliance on this document without written authorization and adoption by Kinney-Horn and Associates, Inc. shall be without liability to Kinney-Horn and Associates, Inc.

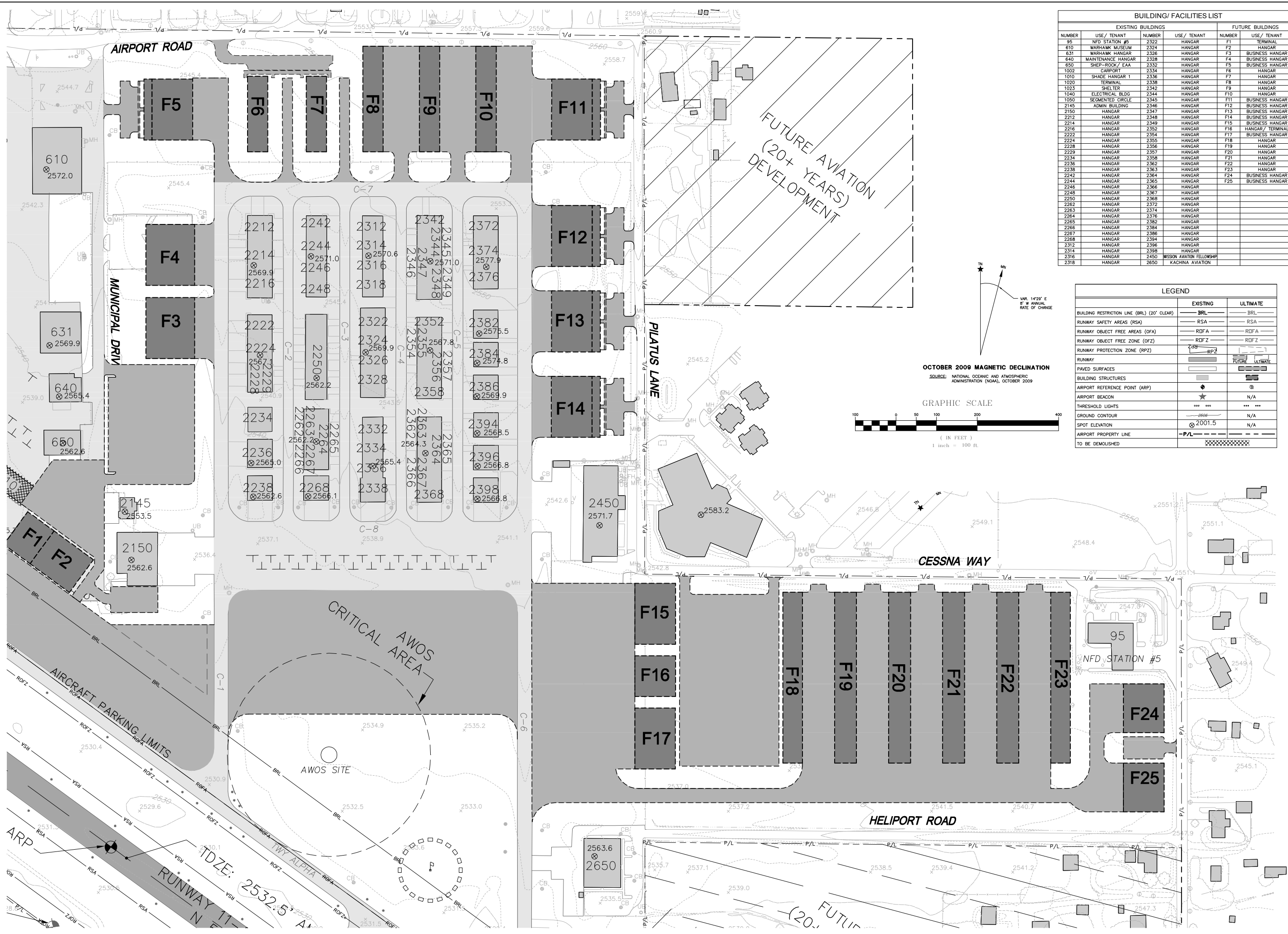

BUILDING/FACILITIES LIST					
EXISTING BUILDINGS			FUTURE BUILDINGS		
NUMBER	USE / TENANT	NUMBER	USE / TENANT	NUMBER	USE / TENANT
95	NFD STATION #5	2322	HANGAR	F1	TERMINAL
610	WARHAWK MUSEUM	2324	HANGAR	F2	HANGAR
631	WARHAWK HANGAR	2326	HANGAR	F3	BUSINESS HANGAR
640	MAINTENANCE HANGAR	2328	HANGAR	F4	BUSINESS HANGAR
650	SHEP-ROCK / EAA	2332	HANGAR	F5	BUSINESS HANGAR
1002	CARPORT	2334	HANGAR	F6	HANGAR
1010	SHADE HANGAR 1	2336	HANGAR	F7	HANGAR
1020	TERMINAL	2338	HANGAR	F8	HANGAR
1023	SHELTER	2342	HANGAR	F9	HANGAR
1040	ELECTRICAL BLDG	2344	HANGAR	F10	HANGAR
1050	SEGMENTED CIRCLE	2345	HANGAR	F11	BUSINESS HANGAR
2145	ADMIN BUILDING	2346	HANGAR	F12	BUSINESS HANGAR
2150	HANGAR	2347	HANGAR	F13	BUSINESS HANGAR
2212	HANGAR	2348	HANGAR	F14	BUSINESS HANGAR
2214	HANGAR	2349	HANGAR	F15	BUSINESS HANGAR
2216	HANGAR	2352	HANGAR	F16	HANGAR / TERMINAL
2222	HANGAR	2354	HANGAR	F17	BUSINESS HANGAR
2224	HANGAR	2355	HANGAR	F18	HANGAR
2228	HANGAR	2356	HANGAR	F19	HANGAR
2229	HANGAR	2357	HANGAR	F20	HANGAR
2234	HANGAR	2358	HANGAR	F21	HANGAR
2236	HANGAR	2362	HANGAR	F22	HANGAR
2238	HANGAR	2363	HANGAR	F23	HANGAR
2242	HANGAR	2364	HANGAR	F24	BUSINESS HANGAR
2244	HANGAR	2365	HANGAR	F25	BUSINESS HANGAR
2246	HANGAR	2366	HANGAR		
2248	HANGAR	2367	HANGAR		
2250	HANGAR	2368	HANGAR		
2262	HANGAR	2372	HANGAR		
2263	HANGAR	2374	HANGAR		
2264	HANGAR	2376	HANGAR		
2265	HANGAR	2382	HANGAR		
2268	HANGAR	2384	HANGAR		
2267	HANGAR	2386	HANGAR		
2268	HANGAR	2394	HANGAR		
2312	HANGAR	2396	HANGAR		
2314	HANGAR	2398	HANGAR		
2316	HANGAR	2450	MISSION AVIATION FELLOWSHIP		
2318	HANGAR	2650	KACHINA AVIATION		

OCTOBER 2009 MAGNETIC DECLINATION
 SOURCE: NATIONAL OCEANIC AND ATMOSPHERIC ADMINISTRATION (NOAA), OCTOBER 2009

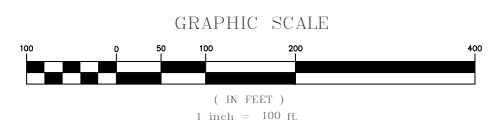

LEGEND		
	EXISTING	ULTIMATE
BUILDING RESTRICTION LINE (BRL) (20' CLEAR)	BRL	BRL
RUNWAY SAFETY AREAS (RSA)	RSA	RSA
RUNWAY OBJECT FREE AREAS (ROFA)	ROFA	ROFA
RUNWAY OBJECT FREE ZONE (OFZ)	ROFZ	ROFZ
RUNWAY PROTECTION ZONE (RPZ)	RPZ	RPZ
RUNWAY	RUNWAY	RUNWAY
PAVED SURFACES	PAVED SURFACES	PAVED SURFACES
BUILDING STRUCTURES	BUILDING STRUCTURES	BUILDING STRUCTURES
AIRPORT REFERENCE POINT (ARP)	ARP	ARP
AIRPORT BEACON	BEACON	N/A
THRESHOLD LIGHTS	THRESHOLD LIGHTS	THRESHOLD LIGHTS
GROUND CONTOUR	GROUND CONTOUR	N/A
SPOT ELEVATION	SPOT ELEVATION	N/A
AIRPORT PROPERTY LINE	P/L	P/L
TO BE DEMOLISHED	TO BE DEMOLISHED	TO BE DEMOLISHED

PREPARED BY: Kinney-Horn and Associates, Inc.

SCALE: 1" = 100'

DRAWN BY: KAG

DESIGNED BY: ADN

CHECKED BY: MDF

NO. 1

DATE

REVISIONS

TERMINAL AREA PLAN
 SHEET 2 OF 2

PREPARED FOR:
 NAMPA MUNICIPAL AIRPORT
 CITY OF NAMPA, IDAHO
 116 MUNICIPAL DRIVE
 NAMPA, IDAHO 83607

DATE: 11/30/2010
 PROJECT NO.: 093504000
 SHEET NUMBER: 4 OF 9