

Drawing name: K:\SNA_Aviation\093504000_Nampa-MP\CADD\VP_TermArea-FD.dwg TAP Nov 23, 2010 1:59pm by: adam.novak
 This document, together with the concepts and designs presented herein, as an instrument of service, is intended only for the specific purpose and client for which it was prepared. Reuse of and improper reliance on this document without written authorization and adaptation by Kimley-Horn and Associates, Inc. shall be without liability to Kimley-Horn and Associates, Inc.

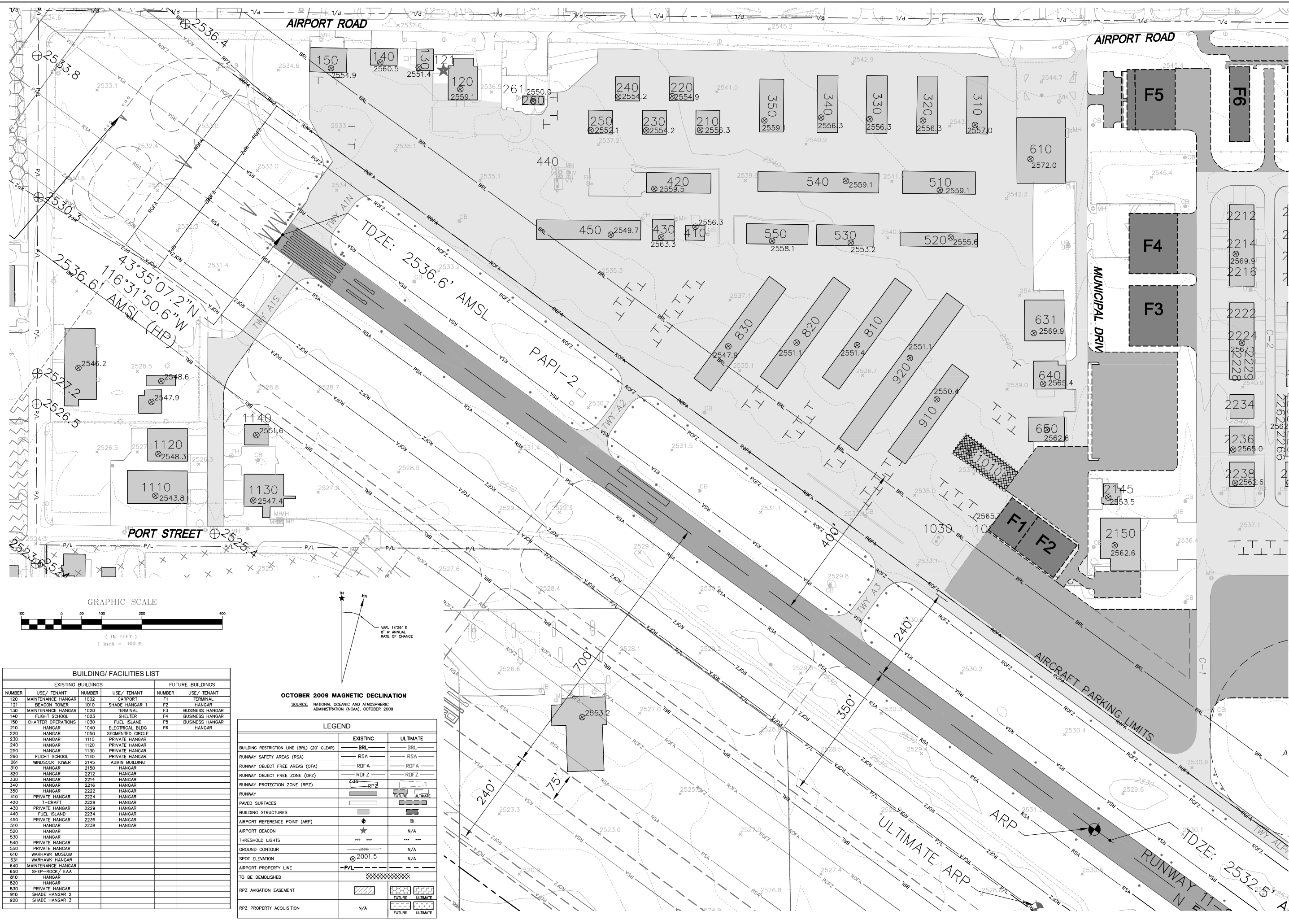

BUILDING/ FACILITIES LIST			
EXISTING BUILDINGS		FUTURE BUILDINGS	
NUMBER	USE/ TENANT	NUMBER	USE/ TENANT
120	MAINTENANCE HANGAR	1002	CARPORP F1
121	BEACON TOWER	1010	SHADE HANGAR 1
130	MAINTENANCE HANGAR	1020	TERMINAL F3
140	FLIGHT SCHOOL	1023	SHED F4
180	CHARTER OPERATIONS	1030	FUEL ISLAND F5
210	HANGAR	1040	ELECTRICAL BLDG F6
220	HANGAR	1050	SEGMENTED CIRCLE
230	HANGAR	1110	PRIVATE HANGAR
240	HANGAR	1120	PRIVATE HANGAR
250	HANGAR	1130	PRIVATE HANGAR
260	FLIGHT SCHOOL	1140	PRIVATE HANGAR
261	WINDSOCK TOWER	2145	ADMIN BUILDING
310	HANGAR	2150	HANGAR
320	HANGAR	2212	HANGAR
330	HANGAR	2214	HANGAR
340	HANGAR	2216	HANGAR
350	HANGAR	2222	HANGAR
410	PRIVATE HANGAR	2224	HANGAR
420	T-CRAFT	2228	HANGAR
430	PRIVATE HANGAR	2229	HANGAR
440	FUEL ISLAND	2234	HANGAR
450	PRIVATE HANGAR	2236	HANGAR
510	HANGAR	2238	HANGAR
520	HANGAR	2238	HANGAR
530	HANGAR		
540	PRIVATE HANGAR		
550	PRIVATE HANGAR		
610	WARHAWK MUSEUM		
631	WARHAWK HANGAR		
640	MAINTENANCE HANGAR		
650	SHED-ROCK/ EAA		
810	HANGAR		
820	HANGAR		
830	PRIVATE HANGAR		
910	SHADE HANGAR 2		
920	SHADE HANGAR 3		

OCTOBER 2009 MAGNETIC DECLINATION
 SOURCE: NATIONAL OCEANIC AND ATMOSPHERIC ADMINISTRATION (NOAA), OCTOBER 2009

	EXISTING	ULTIMATE
BUILDING RESTRICTION LINE (BRL) (20' CLEAR)	BRL	BRL
RUNWAY SAFETY AREAS (RSA)	RSA	RSA
RUNWAY OBJECT FREE AREAS (OFA)	ROFA	ROFA
RUNWAY OBJECT FREE ZONE (OFZ)	ROFZ	ROFZ
RUNWAY PROTECTION ZONE (RPZ)	RPZ	RPZ
RUNWAY		FUTURE ULTIMATE
PAVED SURFACES		FUTURE ULTIMATE
BUILDING STRUCTURES		FUTURE ULTIMATE
AIRPORT REFERENCE POINT (ARP)	*	*
AIRPORT BEACON	★	N/A
THRESHOLD LIGHTS	***	***
GROUND CONTOUR	-000-	N/A
SPOT ELEVATION	⊕ 2001.5	N/A
AIRPORT PROPERTY LINE	-P/L	
TO BE DEMOLISHED	XXXXXX	
RPZ AVIATION EASEMENT	▨	FUTURE ULTIMATE
RPZ PROPERTY ACQUISITION	N/A	FUTURE ULTIMATE

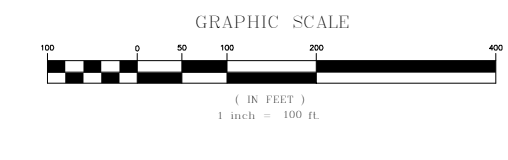

SCALE 1"=100'
 DRAWN BY KAG
 DESIGNED BY ADN
 CHECKED BY MDF

PREPARED BY

 Kimley-Horn and Associates, Inc.

TERMINAL AREA PLAN
 SHEET 1 OF 2

PREPARED FOR

 NAMPAMUNICIPAL AIRPORT
 CITY OF NAMPAMUNICIPAL DRIVE
 NAMPAMUNICIPAL DRIVE

DATE 11/30/2010
 PROJECT NO. 093504000
 SHEET NUMBER 3 OF 9

REVISIONS
 No. DATE BY